

TestMate® Series

ET-100-6 The "Original" TestMate®

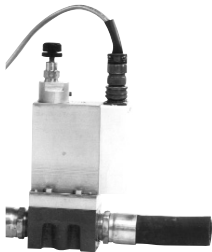

Pressure meter has low and high scale, and battery check.

Flow meter includes low and high scale, and temperature scale.

Auxiliary pressure output allows attachment to oscilloscope.

Three-position selector switches are easy to operate.

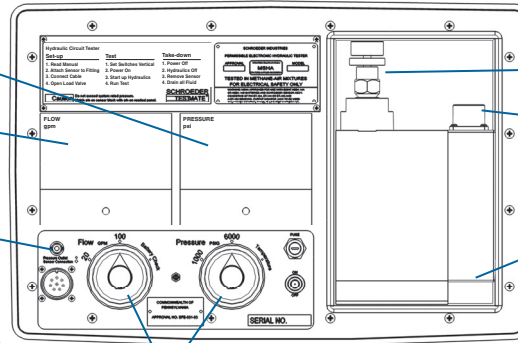

Load valve can generate 6000 psi.

9' cable connects sensor to TestMate®.

Captive sensor bolts cannot get lost.

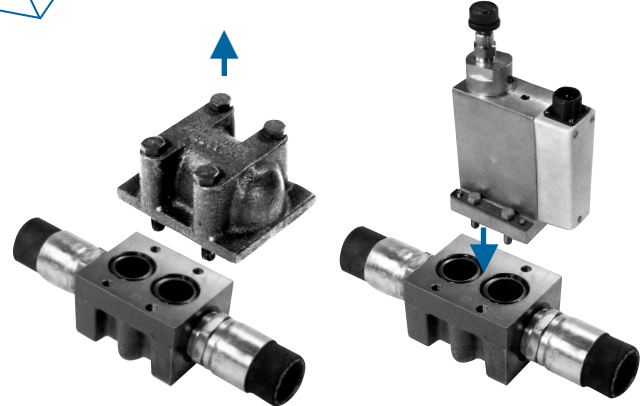

Description

Schroeder's original TestMate® system with the patented EasyTest™ fitting provides the hydraulic user with a quick, convenient method to test, troubleshoot, and obtain preventive maintenance data on hydraulic systems. Flows up to 100 gpm and pressures up to 6000 psi, as well as operating temperature, are measured through an EasyTest™ fitting, which is permanently installed in the hydraulic system.

The sensor and EasyTest™ fittings are robust units designed to operate safely at any system pressure up to the maximum 6000 psi that the sensor load valve is capable of generating. Pressure bearing parts are thick-section aluminum extrusions carefully chosen for their combination of high strength and light weight.

If the system's prime mover is kept at constant rpm, any drop in indicated flow will represent a loss of system efficiency at the point of test. During testing, system operation can be used to create the load, or the load can be simulated with the load valve in the sensor block.

The electronic circuitry produces data that accurately reflects system performance at each test point throughout the operating pressure range, making it possible to also determine pump and motor efficiency as well as valve and cylinder leakage.

Features

- Easy to use—for beginner or experienced troubleshooters
- Large meters—are clearly marked with easy-to-read scales
- Scale selector switches and the load valve control knob are also large and specially designed to be easy to grip under any conditions
- All loose components are stowed in form-fitting recesses in the impact resistant plastic case that also protects the meters and circuitry
- The electronic sensor and the EasyTest™ fitting are the only components that see hydraulic fluid, so clean-up is limited to draining the sensor and replacing the cap on the EasyTest™ fitting
- The load valve allows the operator to simulate operating pressure, if required

Applications

- Check systems before and after rebuild
- Use as part of a preventive maintenance program
- Use to troubleshoot in instances of poor system performance or excessive machine downtime
- Use to check performance on a production line
- Install EasyTest™ fittings on prototypes to accurately evaluate hydraulic performance at any stage of development

TestMate® Series

Flow Meter:	Type:	Electronic turbine
	Low Scale Range:	0 to 20 gpm (0 to 75.7 L/min)
	Low Scale Accuracy:	±1 gpm @ 3 to 5 gpm (11-19 L/min) ±0.2 gpm @ 6 to 20 gpm (22.7-75.7 L/min)
	High Scale Range:	0 to 100 gpm (0 to 378.5 L/min)
	High Scale Accuracy:	±2% of full scale
	Minimum Reading:	3 gpm (11.35 L/min)
Pressure Meter:	Type:	Electronic transducer
	Low Scale Range:	0 to 1000 psi (0 to 3784 L/min)
	Low Scale Accuracy:	±35 psi (2.41 bar)
	High Scale Range:	0 to 6000 psi (0 to 413.8 bar)
	High Scale Accuracy:	±120 psi (8.44 bar)
	Auxiliary Pressure Output:	BNC connector - 2.5 mv @ 0.1mA per 1000 psi (68.96 bar), linear in the range 0 to 6000 psi (0 to 413.8 bar), independent of meter scale selection
	Temperature Scale:	50°F to 250°F (10°C to 121°C)
	Power Source:	8 "C" size batteries <i>To be furnished by customer</i>
	Weight:	18 lbs (8 kg)
	Case Dimensions:	19.87 x 13.93 x 4.68 in (50.4 x 35.4 x 11.9 cm)
	EasyTest Fitting Envelope Dimensions:	4.5 x 4 x 3 in (114 x 102 x 76 mm)
	EasyTest Fitting Mounting Holes:	Qty 2 - .375 to 16 UNC .75 dp.
	Clearance to Install Sensor:	11 in (280 mm) min

How to Build a Valid Model Number for a Schroeder Original TestMate®:

BOX 1	BOX 2
ET-100-6	

Example: NOTE: One option per box

BOX 1	BOX 2
ET-100-6	

BOX 1	BOX 2
Model	Option
ET-100-6 Original TestMate®	C = MSHA approved

Note:

Box 2: Required for any underground coal mining application. Unit will be furnished with the required MSHA tag.

Port Type and Size	Model Numbers		Port Type and Size	Model Numbers	
	Station with Through Flow for In-Line Testing	Station with Blocked Flow for "T" Testing		Station with Through Flow for In-Line Testing	Station with Blocked Flow for "T" Testing
NPTF	0.75	A-ET-211	SAE 4-Bolt Boss ²	0.75	A-ET-219
	1.00	A-ET-212		1.00	A-ET-220
	1.25	A-ET-213			
	1.50 ¹	A-ET-256			
SAE O-Ring	1.06-12	A-ET-215	BSP PL	0.75	A-ET-222
	1.3125-12	A-ET-216		1.00	A-ET-223
	1.625-12	A-ET-217		1.25	A-ET-224
	1.875-12 ¹	A-ET-258			

¹For 3000 psi only

²Depth of holes not per SAE specifications

Specifications

- TCM
- TCM-FC
- TSU
- TMU
- TPM
- TIM
- TMS
- CTU
- TWS-C
- ET-100-6**

- HMG 3000
- EPK
- HTB
- GS

Trouble Check Plus

Test Points

Adapters

Hose Joiners

Model Number Selection

Microflex Hose

Pressure Limiters

Pressure Gauges

Test Kits

Probalizer

Filtration Station

MFS, MFD

AMS, AMD

KLS, KLD

AKS, AKD

KLC

X Series

MTS

HFS

SVD

TDS-A

TDS-E

IXU

Appendix