



BIODIESEL PURIFICATION REPLACEMENT PARTS & ACCESSORIES

Schroeder Meltblown



The Schroeder Meltblown Cartridges and Housings are a reliable, versatile and low cost solution to numerous filtration needs. These graded density elements, made from 100% pure polypropylene fibers, offer a high dirt holding capacity. By trapping the larger sized particles on the outside of the element, while the smaller particles are trapped closer to the element's core, these elements can filter as fine as 1 μ , while still maintaining a low pressure drop. This product line offers various sizes and styles of housings to fit a wide variety of applications.

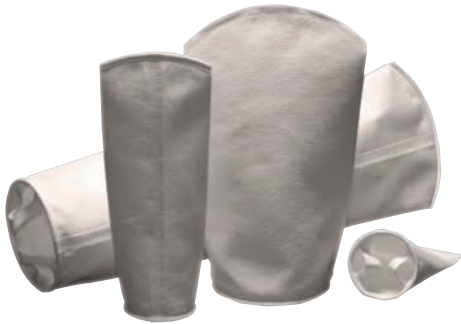

The disposable bag elements offered by Schroeder come in a wide variety of materials, sizes and styles. Bag styles include: steel ring bags (stainless steel optional) that are sewn into top of bag, plastic flange bags that have flange sewn at top of bag and draw string. A multitude of options are available, call factory for details. Polyester and polypropylene felt can be used for filtration as low as 1 micron, while monofilament and multifilament bags can be used for more coarse filtration. Felt bags are either singed or glazed to prevent fiber migration on the clean side of the filter.

Micron Rated Filter Bags

*Please see Process Filtration Catalog for drawings and complete sizing information.